

SAFETY GRATING

Heavy Duty Series 2-Diamond Plank - 9-1/4" Width

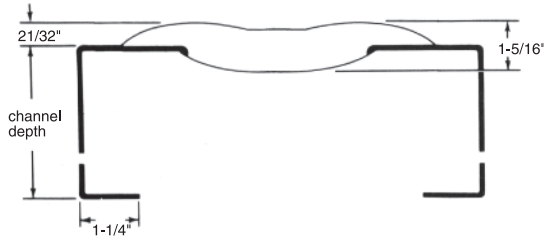

Available in Galvanized, Carbon and 9Ga. Steel

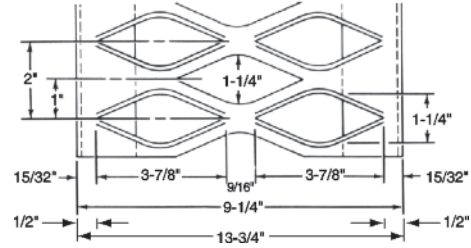

PLANK SELECTION & DESIGN LOADS/DEFLECTIONS

Material Gauge	Plank		Clear Span																			
	Channel Depth in. (mm)	Weights lbs./ft.	20"	2'6"	3'0"	3'6"	4'0"	4'6"	5'0"	5'6"	6'0"	6'6"	7'0"	7'6"	8'0"	9'0"	10'0"	11'0"	12'0"			
STEEL 10 ga.	2	7.4	U	2681	1716	1141	876	699	529	428	354	300	253	218	191	167	132	109	90	74		
			D	0.05	0.08	0.11	0.15	0.19	0.24	0.30	0.35	0.41	0.47	0.54	0.62	0.69	0.85	1.04	1.24	1.45		
			C	2067	1653	1378	1181	1033	919	827	752	689	636	590	551	517	459	413	376	344		
			D	0.04	0.06	0.09	0.12	0.15	0.19	0.24	0.28	0.33	0.38	0.44	0.49	0.55	0.68	0.81	0.98	1.16		
	2-1/2	7.9	U	4063	2600	1806	1327	1016	802	650	537	451	385	331	288	253	202	163	136	113		
			D	0.05	0.07	0.10	0.14	0.18	0.23	0.27	0.32	0.36	0.42	0.49	0.55	0.62	0.79	0.96	1.15	1.35		
			C	3133	2507	2089	1790	1567	1393	1253	1139	1044	964	895	836	783	696	627	570	522		
			D	0.04	0.06	0.08	0.11	0.14	0.18	0.22	0.25	0.29	0.34	0.39	0.44	0.50	0.63	0.76	0.91	1.08		
	3	8.4	U	4324	2767	1923	1413	1082	852	692	572	479	409	354	307	269	214	171	144	121		
			D	0.04	0.06	0.08	0.11	0.15	0.18	0.22	0.26	0.30	0.34	0.39	0.44	0.48	0.58	0.68	0.80	0.95		
			C	3333	2667	2222	1905	1667	1481	1311	1212	1111	1026	952	889	833	741	667	606	556		
			D	0.03	0.05	0.07	0.09	0.12	0.15	0.17	0.21	0.24	0.28	0.31	0.35	0.39	0.47	0.55	0.64	0.76		
4	10.3	U	7091	4538	3152	2316	1775	1401	1136	938	786	673	580	506	444	350	284	234	195			
		D	0.03	0.05	0.07	0.09	0.12	0.14	0.17	0.20	0.23	0.27	0.31	0.35	0.39	0.47	0.56	0.66	0.78			
		C	5467	4373	3644	3124	2733	2430	2187	1988	1822	1682	1562	1458	1367	1215	1039	994	911			
		D	0.03	0.04	0.06	0.07	0.09	0.11	0.14	0.16	0.19	0.22	0.25	0.28	0.31	0.38	0.45	0.53	0.63			

H-SERIES-Heavy Duty GRIP STRUT®

Gratings for greater loads, safer walking

- High strength-to-weight ratio - efficient structural design means large load capacity with low dead weight
- Slip-resist serrated surface - grips shoes tightly (exceeds Federal Spec. RR-G-1602A slip resistance requirements)
- Open design - sheds slip-causing stones, dirt and debris
- Slip-resisting serrated or less harsh non-serrated wearing surfaces tailor long life to diverse service conditions
- Complete line of products, design data and support services
- Handrail brackets available for maximum safety and meets OSHA requirements
- Splice plates speed assembly without welding

Heavy Duty Series 3-Diamond Plank - 13-3/4" Width

Available in Galvanized, Carbon and 9Ga. Steel

PLANK SELECTION & DESIGN LOADS/DEFLECTIONS

Material Gauge	Plank		Clear Span																			
	Channel Depth in. (mm)	Weights lbs./ft.	20"	2'6"	3'0"	3'6"	4'0"	4'6"	5'0"	5'6"	6'0"	6'6"	7'0"	7'6"	8'0"	9'0"	10'0"	11'0"	12'0"			
STEEL 10 ga.	2	9.5	U	1804	1154	801	589	450	356	288	238	202	170	147	128	113	89	73	60	50		
			D	0.05	0.08	0.11	0.15	0.19	0.24	0.30	0.35	0.41	0.47	0.54	0.62	0.69	0.85	1.04	1.24	1.45		
			C	2067	1653	1378	1181	1033	919	827	752	689	636	590	551	517	459	413	376	344		
			D	0.04	0.06	0.09	0.12	0.15	0.19	0.24	0.28	0.33	0.38	0.44	0.49	0.55	0.68	0.81	0.98	1.16		
	2-1/2	10.0	U	2733	1794	1214	893	683	539	437	361	304	259	223	194	170	136	110	92	76		
			D	0.05	0.07	0.10	0.14	0.18	0.23	0.27	0.32	0.36	0.42	0.49	0.55	0.62	0.79	0.96	1.15	1.35		
			C	3133	2507	2089	1790	1567	1393	1253	1139	1044	964	895	836	783	696	627	570	522		
			D	0.04	0.06	0.08	0.11	0.14	0.18	0.22	0.25	0.29	0.34	0.39	0.44	0.50	0.63	0.76	0.91	1.08		
	3	10.5	U	2909	1862	1293	950	728	573	466	385	322	275	238	207	181	144	115	97	81		
			D	0.04	0.06	0.08	0.11	0.15	0.18	0.22	0.26	0.30	0.34	0.39	0.44	0.48	0.58	0.68	0.80	0.95		
			C	3333	2667	2222	1905	1667	1481	1311	1212	1111	1026	952	889	833	741	667	606	556		
			D	0.03	0.05	0.07	0.09	0.12	0.15	0.17	0.21	0.24	0.28	0.31	0.35	0.39	0.47	0.56	0.64	0.76		
4	11.4	U	4770	3063	2121	1558	1194	943	765	631	529	453	390	340	298	236	191	157	131			
		D	0.03	0.05	0.07	0.09	0.12	0.14	0.17	0.20	0.23	0.27	0.31	0.35	0.39	0.47	0.56	0.66	0.78			
		C	5467	4373	3644	3124	2733	2430	2187	1988	1822	1682	1562	1458	1367	1215	1039	994	911			
		D	0.03	0.04	0.06	0.07	0.09	0.11	0.14	0.16	0.19	0.22	0.25	0.28	0.31	0.38	0.45	0.53	0.63			

Heavy Duty GRIP STRUT® Safety Grating products offer the advantages of Regular GRIP STRUT® Safety Grating, but are designed for applications of greater load and/or longer span. Basic design is the same but diamond openings are larger and metal is thicker.

Heavy-Duty Grating products are available in many of the same configurations, materials and finishes as Regular GRIP STRUT® Grating products and include planks, walkways and stairtreads.

SAFETY GRATING

Available in Galvanized, Carbon and 9Ga. Steel

Heavy Duty Series 5-Diamond Plank - 23-1/4" Width

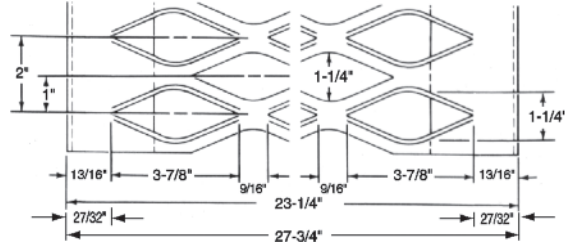
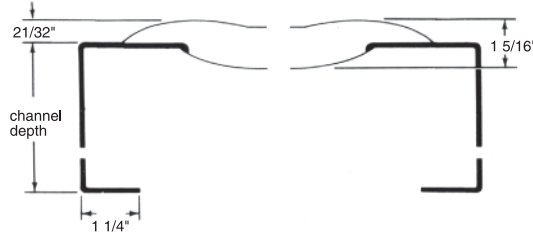

PLANK SELECTION & DESIGN LOADS/DEFLECTIONS

Material Gauge	Plank		Clear Span																	
	Channel Depth in. (mm)	Weights lbs./ft.	2'0"	2'6"	3'0"	3'6"	4'0"	4'6"	5'0"	5'6"	6'0"	6'6"	7'0"	7'6"	8'0"	9'0"	10'0"	11'0"	12'0"	
STEEL 10 ga.	2	14.4	U	1034	661	459	337	258	204	165	136	116	97	84	73	65	51	42	34	29
			D	0.04	0.06	0.08	0.11	0.14	0.18	0.22	0.25	0.29	0.34	0.39	0.44	0.50	0.63	0.76	0.91	1.08
			C	2067	1653	1378	1181	1033	919	827	752	689	636	590	551	517	459	413	376	344
			D	0.04	0.06	0.09	0.12	0.15	0.19	0.24	0.28	0.33	0.38	0.44	0.49	0.55	0.68	0.81	0.98	1.16
	2-1/2	14.9	U	1617	1034	718	528	404	319	259	214	180	153	132	115	101	81	65	54	45
			D	0.05	0.07	0.10	0.14	0.18	0.23	0.27	0.32	0.36	0.42	0.49	0.55	0.62	0.79	0.96	1.15	1.35
			C	3133	2507	2089	1790	1567	1393	1253	1139	1044	964	895	836	783	696	627	570	522
			D	0.04	0.06	0.08	0.11	0.14	0.18	0.22	0.25	0.29	0.34	0.39	0.44	0.50	0.63	0.76	0.91	1.08
	3	15.4	U	1720	1101	765	562	430	339	276	228	190	163	141	122	107	85	68	57	48
			D	0.04	0.06	0.08	0.11	0.15	0.18	0.22	0.26	0.30	0.34	0.39	0.44	0.48	0.58	0.68	0.80	0.95
			C	3333	2667	2222	1905	1667	1481	1311	1212	1111	1026	952	889	833	741	667	606	556
			D	0.03	0.05	0.07	0.09	0.12	0.15	0.17	0.21	0.24	0.28	0.31	0.35	0.39	0.47	0.55	0.64	0.76
4	16.4	U	2821	1805	1254	921	706	557	452	373	312	268	231	201	177	139	113	93	77	
		D	0.03	0.05	0.07	0.09	0.12	0.14	0.17	0.20	0.23	0.27	0.31	0.35	0.39	0.47	0.56	0.66	0.78	
		C	5467	4373	3644	3124	2733	2430	2187	1988	1822	1682	1562	1458	1367	1215	1039	994	911	
		D	0.03	0.04	0.06	0.07	0.09	0.11	0.14	0.16	0.19	0.22	0.25	0.28	0.31	0.38	0.45	0.53	0.63	

Heavy Duty Series 6-Diamond Plank - 27-3/4" Width

Available in Galvanized, Carbon and 9Ga. Steel

PLANK SELECTION & DESIGN LOADS/DEFLECTIONS

Material Gauge	Plank		Clear Span																	
	Channel Depth in. (mm)	Weights lbs./ft.	2'0"	2'6"	3'0"	3'6"	4'0"	4'6"	5'0"	5'6"	6'0"	6'6"	7'0"	7'6"	8'0"	9'0"	10'0"	11'0"	12'0"	
STEEL 10 ga.	2	16.2	U	923	590	410	301	230	182	147	122	103	87	75	66	58	46	37	31	25
			D	0.05	0.08	0.11	0.15	0.19	0.24	0.30	0.35	0.41	0.47	0.54	0.62	0.69	0.85	1.04	1.24	1.45
			C	2067	1653	1378	1181	1033	919	827	752	689	636	590	551	517	459	413	376	344
			D	0.04	0.06	0.09	0.12	0.15	0.19	0.24	0.28	0.33	0.38	0.44	0.49	0.55	0.68	0.81	0.98	1.16
	2-1/2	16.7	U	1398	894	621	457	349	276	224	185	156	132	114	99	87	70	56	47	39
			D	0.05	0.07	0.10	0.14	0.18	0.23	0.27	0.32	0.36	0.42	0.49	0.55	0.62	0.79	0.96	1.15	1.35
			C	3133	2507	2089	1790	1567	1393	1253	1139	1044	964	895	836	783	696	627	570	522
			D	0.04	0.06	0.08	0.11	0.14	0.18	0.22	0.25	0.29	0.34	0.39	0.44	0.50	0.63	0.76	0.91	1.08
	3	17.2	U	1488	952	662	486	372	293	239	197	164	141	122	106	93	74	59	49	42
			D	0.04	0.06	0.08	0.11	0.15	0.18	0.22	0.26	0.30	0.34	0.39	0.44	0.48	0.58	0.68	0.80	0.95
			C	3333	2667	2222	1905	1667	1481	1311	1212	1111	1026	952	889	833	741	667	606	556
			D	0.03	0.05	0.07	0.09	0.12	0.15	0.17	0.21	0.24	0.28	0.31	0.35	0.39	0.47	0.55	0.64	0.76
4	18.2	U	2440	1561	1085	797	611	482	391	323	270	232	200	174	153	120	98	80	67	
		D	0.03	0.05	0.07	0.09	0.12	0.14	0.17	0.20	0.23	0.27	0.31	0.35	0.39	0.47	0.56	0.66	0.78	
		C	5467	4373	3644	3124	2733	2430	2187	1988	1822	1682	1562	1458	1367	1215	1039	994	911	
		D	0.03	0.04	0.06	0.07	0.09	0.11	0.14	0.16	0.19	0.22	0.25	0.28	0.31	0.38	0.45	0.53	0.63	

SAFETY GRATING

Available in Galvanized, Carbon and 9Ga. Steel

Heavy Duty Series 8-Diamond Plank - 36" Width

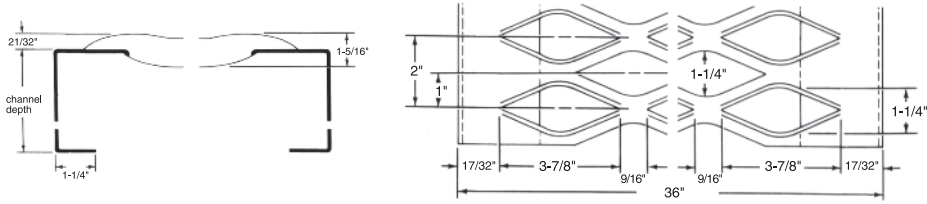

PLANK SELECTION & DESIGN LOADS/DEFLECTIONS

Material Gauge	Plank		Clear Span																	
	Channel Depth in. (mm)	Weights lbs./ft.	2'0"	2'6"	3'0"	3'6"	4'0"	4'6"	5'0"	5'6"	6'0"	6'6"	7'0"	7'6"	8'0"	9'0"	10'0"	11'0"	12'0"	
STEEL 10 ga.	2	19.9	U	689	441	306	225	172	136	110	91	77	65	56	49	43	34	28	23	19
			D	0.05	0.08	0.11	0.15	0.19	0.24	0.30	0.35	0.41	0.47	0.54	0.62	0.69	0.85	1.04	1.24	1.45
			C	2067	1653	1378	1181	1033	919	827	752	689	636	590	551	517	459	413	376	344
			D	0.04	0.06	0.09	0.12	0.15	0.19	0.24	0.28	0.33	0.38	0.44	0.49	0.55	0.68	0.81	0.98	1.16
	2-1/2	20.4	U	1044	668	464	341	261	206	167	138	116	99	85	74	65	52	42	35	29
			D	0.05	0.07	0.10	0.14	0.18	0.23	0.27	0.32	0.36	0.42	0.49	0.55	0.62	0.79	0.96	1.15	1.35
			C	3133	2507	2089	1790	1567	1393	1253	1139	1044	964	895	836	783	696	627	570	522
			D	0.04	0.06	0.08	0.11	0.14	0.18	0.22	0.25	0.29	0.34	0.39	0.44	0.50	0.63	0.76	0.91	1.08
	3	20.9	U	1111	711	494	363	278	219	178	147	123	105	91	79	69	55	44	37	31
			D	0.04	0.06	0.08	0.11	0.15	0.18	0.22	0.26	0.30	0.34	0.39	0.44	0.48	0.58	0.68	0.80	0.95
			C	3333	2667	2222	1905	1667	1481	1311	1212	1111	1026	952	889	833	741	667	606	556
			D	0.03	0.05	0.07	0.09	0.12	0.15	0.17	0.21	0.24	0.28	0.31	0.35	0.39	0.47	0.55	0.64	0.76
4	21.8	U	1822	1166	810	595	456	360	292	241	202	173	149	130	114	90	73	60	50	
		D	0.03	0.05	0.07	0.09	0.12	0.14	0.17	0.20	0.23	0.27	0.31	0.35	0.39	0.47	0.56	0.66	0.78	
		C	5467	4373	3644	3124	2733	2430	2187	1988	1822	1682	1562	1458	1367	1215	1039	994	911	
		D	0.03	0.04	0.06	0.07	0.09	0.11	0.14	0.16	0.19	0.22	0.25	0.28	0.31	0.38	0.45	0.53	0.63	

SAFETY GRATING



Grip Strut Walkway - Safe Loading Tables

5-Diamond Planks - 24" Width / 5" Deep - "H" Series

6-Diamond Planks - 30" Width / 5" Deep - "H" Series

8-Diamond Planks - 36" Width / 5" Deep - "H" Series

Steel Walkway Selection Design Loads/Deflections

Allowable Loads and Deflections: U=Uniform Load (lb./ft.²) C= Concentrated Load (lb.) D=Deflection (in.)

Steel Width Diamond	Material Gauge	Weight lb./lin. ft. (kg/m)		Span																
				4'-0"	5'-0"	6'-0"	7'-0"	8'-0"	9'-0"	10'-0"	11'-0"	12'-0"	13'-0"	14'-0"	15'-0"	16'-0"	18'-0"	20'-0"	22'-0"	24'-0"
24" 5-Dia	11 ga.	15.4 (22.9)	U	750	480	334	245	187	148	120	99	83	71	62	54	47	37	30	25	21
			D	.34	.35	.38	.34	.34	.34	.35	.42	.50	.59	.69	.79	.91	1.13	1.43	1.70	2.03
			C	3000	2400	2000	1714	1500	1334	1200	1091	1000	922	857	800	750	666	600	546	500
			D	.27	.28	.31	.28	.28	.27	.28	.34	.41	.48	.56	.63	.72	.91	1.13	1.36	1.62
24" 5-Dia	10 ga.	17.5 (26.0)	U	937	600	417	306	234	185	150	124	104	89	77	67	59	46	38	31	26
			D	.38	.39	.42	.38	.38	.38	.39	.47	.56	.66	.77	.88	1.01	1.26	1.59	1.89	2.25
			C	3750	3000	2500	2143	1875	1667	1500	1364	1250	1153	1071	1000	938	833	750	682	625
			D	.30	.31	.34	.31	.30	.30	.31	.36	.45	.53	.61	.70	.80	1.01	1.25	1.51	1.80
24" 5-Dia	9 ga.	19.6 (29.1)	U	1031	660	459	337	257	204	165	136	114	98	85	74	65	51	42	34	29
			D	.38	.39	.42	.38	.38	.38	.39	.47	.56	.66	.77	.88	1.01	1.26	1.59	1.89	2.25
			C	4125	3300	2750	2357	2063	1834	1650	1500	1375	1268	1178	1100	1032	916	825	750	688
			D	.30	.31	.34	.31	.30	.30	.31	.36	.45	.53	.61	.70	.80	1.01	1.25	1.51	1.80
30" 6-Dia	11 ga.	17.7 (26.3)	U	732	468	325	239	183	145	116	96	81	69	60	52	45	36	28	24	20
			D	.33	.39	.36	.36	.41	.38	.37	.37	.44	.51	.59	.68	.77	.98	1.20	1.46	1.73
			C	3667	2932	2444	2095	1832	1629	1467	1333	1222	1128	1047	977	916	815	732	667	610
			D	.27	.31	.29	.29	.33	.31	.30	.30	.35	.41	.48	.55	.62	.78	.97	1.17	1.40
30" 6-Dia	10 ga.	19.9 (29.6)	U	916	586	407	299	229	182	146	121	102	87	75	65	57	45	36	30	25
			D	.37	.43	.40	.40	.46	.42	.41	.41	.49	.57	.66	.75	.86	1.09	1.33	1.62	1.92
			C	4584	3666	3056	2619	2291	2037	1834	1667	1528	1410	1309	1222	1146	1019	916	834	763
			D	.30	.34	.32	.32	.37	.34	.33	.33	.39	.45	.53	.61	.69	.87	1.08	1.30	1.55
30" 6-Dia	9 ga.	22.1 (32.9)	U	1007	644	447	328	251	200	160	133	112	95	82	71	62	49	39	33	27
			D	.37	.43	.40	.40	.46	.42	.41	.41	.49	.57	.66	.75	.86	1.09	1.33	1.62	1.92
			C	5042	4032	3361	2880	2530	2240	2017	1833	1680	1551	1439	1344	1260	1120	1007	917	839
			D	.30	.34	.32	.32	.37	.34	.33	.33	.39	.45	.53	.61	.69	.87	1.08	1.30	1.55
36" 8-Dia	11 ga.	20.2 (30.0)	U	444	284	197	144	111	88	71	58	49	42	36	31	28	21	17	14	12
			D	.35	.35	.30	.29	.30	.32	.35	.38	.46	.54	.62	.71	.82	1.04	1.26	1.50	1.78
			C	2664	2133	1777	1524	1333	1184	1066	969	888	820	761	711	666	592	533	484	444
			D	.28	.28	.23	.23	.23	.26	.28	.31	.37	.43	.50	.58	.65	.83	1.02	1.23	1.47
36" 8-Dia	10 ga.	22.7 (33.8)	U	556	356	247	181	139	110	89	73	62	53	45	39	35	27	22	18	15
			D	.39	.39	.33	.32	.33	.36	.39	.42	.51	.60	.69	.79	.91	1.15	1.40	1.67	1.98
			C	3330	2667	2222	1905	1667	1481	1333	1212	1111	1026	952	889	833	741	667	606	556
			D	.31	.31	.26	.26	.26	.29	.31	.34	.41	.46	.55	.64	.72	.92	1.13	1.37	1.63
36" 8-Dia	9 ga.	25.3 (37.6)	U	611	391	271	199	152	121	97	80	68	58	49	42	38	29	24	19	16
			D	.39	.39	.33	.32	.33	.36	.39	.42	.51	.60	.69	.79	.91	1.15	1.40	1.67	1.98
			C	3663	2933	2444	2095	1833	1629	1466	1333	1222	1128	1047	977	916	815	733	666	611
			D	.31	.31	.26	.26	.26	.29	.31	.34	.41	.46	.55	.64	.72	.92	1.13	1.37	1.63

Note: 10 ga. thickness most readily available and 9 ga. & 11 ga. are production run only